

Descrizione / Description / Description

Miscelatore elettronico ad incasso per installazione a parete

Concealed wall - mounted electronic mixer

Mitigeur électronique encastrable pour installation mural

Materiali / Materials / Matériels

Componenti in finitura  
Finishing components  
Composants en finition

Acciaio Inox / Stainless steel / Acier inoxydable

Componenti torniti  
Machined components  
Composants tournés

Ottone / Brass / Laiton

Guarnizioni  
Gaskets  
Joints

EPDM

Componenti plastica  
Plastic components  
Composants en plastique

POM

Finitura superficiale  
Surface finishing  
Finition de la surface

Conforme / According / Conformément EN 248

In accordo alla EN 9227 in merito all'aggressione salina  
According to EN 9227 regarding saline aggression  
Conformément à la norme EN 9227 concernant l'agression saline

Caratteristiche rubinetti con sensore IR  
Features IR sensor taps  
Caractéristiques des robinets avec capteur infrarouge

Distanza di esercizio Operating distance Distance de fonctionnement	0.5-20	Cm
---	--------	----

Tempo di apertura Opening time Temps d'ouverture	7,5	sec
--	-----	-----

Sistema antivandalo Anti-vandal system Système anti-vandalisme	5	min
--	---	-----

Sistema anti legionella Anti legionella system Système anti-légionelles	24	ore hours heures
---	----	------------------------

Immagine / Picture / Image

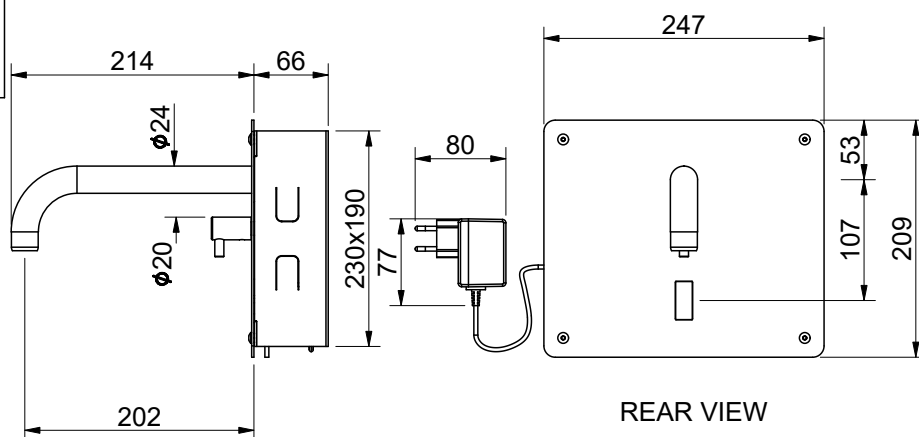

Caratteristiche / Features

	5 - 70 °C
--	-----------

	230/6V DC
---	-----------

	12 l/min (3 bar)
--	------------------

	Min 0.5 - Max 6 (Recommended 2-4) bar
--	---------------------------------------

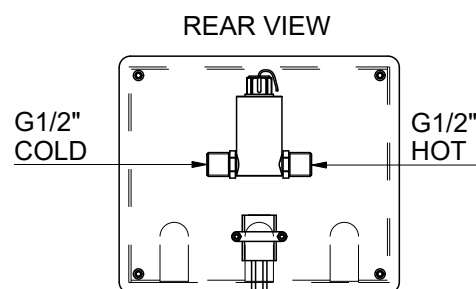

RUBINETTERIE MCM Int. S.r.l.  
via dell'Acacia, 54/56 - 28021 Borgomanero (NO)  
Tel : +39 0322 843060 - Fax : +39 0322 831613  
E-mail : info@mcmtaps.it - web : www.mcmtaps.it  
P IVA : IT017877240033



Art. 7013C

1701300R00AL00000

4



100% Made in Italy